

PHASE 2 - Proposed Site Plan

existing trees/hedgerow retained to be trimmed back as required.
 existing public right of way footpath to be upgrade to a 1.5m wide tarmac finish footpath

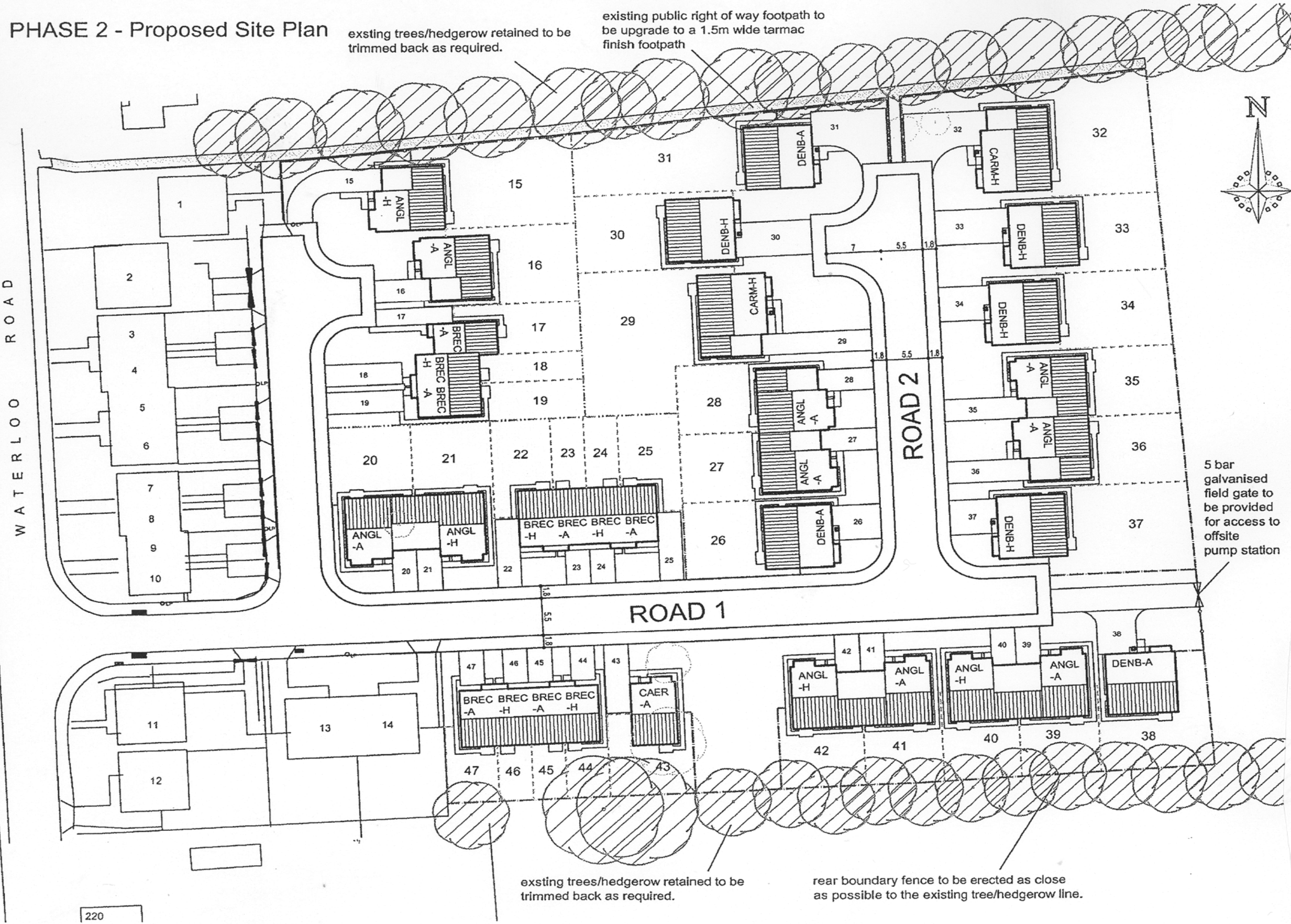

HOUSE TYPE SCHEDULE

BREC	Brecon	2 bed	672sqft	-11
CAER	Caernarfon	3 bed	914sqft	- 1
ANGL	Anglesey	3 bed	1015sqft	-12
DENB	Denbigh	4 bed	1306sqft	- 7
CARM	Cardiganshire	4 bed	1546sqft	- 2
TOTAL NO UNITS				-33
TOTAL SQFT				- 32,720sqft

NOTES

- 1.8m HIGH STAINED CLOSE BOARD FENCE.
- 1.2m HIGH STAINED CLOSE BOARD FENCE.
- 0.9M HIGH TIMBER POST AND CHAIN LINK FENCE
- 1.2M HIGH TIMBER POST AND RAIL FENCE

SURFACE FINISHES
 Roads and pavements - bitumen macadam
 Pavement crossovers - to specification
 Shared driveway - bitumen macadam
 Private driveway - bitumen macadam
 Paths and footpaths - precast concrete slabs
 Demarcation - to be 150x50mm pc concrete edging set flush with ground.

SITE ROADS AND STREET LIGHTING
 All to be to council requirements and adoptable standards.

- TREES TO BE RETAINED
- TREES TO BE REMOVED
- PUBLIC RIGHT OF WAY

5 bar galvanised field gate to be provided for access to offsite pump station

existing trees/hedgerow retained to be trimmed back as required.

rear boundary fence to be erected as close as possible to the existing tree/hedgerow line.

220

STUDENT.....

A3 PLAN MUST BE SUBMITTED WITH COURSEWORK AND BOUND INTO ASSIGNMENT